



AVAILABLE · JUNE 2026

OFFICE SPACE FOR LEASE · SANTA BARBARA MESA

# 1933 Cliff Drive Suite 6

Ground-floor office with garden atrium access, steps from the Pacific

TOTAL SIZE

**1,497**  
square feet

BASE RENT

**\$2.50**  
per sq. ft. / month

NNN

**\$0.89**  
per sq. ft. / month

AVAILABLE

**June**  
2026

## ABOUT THE SPACE

A rare opportunity to lease a beautifully designed 1,497 sq. ft. ground-floor office suite in Santa Barbara's Mesa neighborhood. Recognizable Spanish-style office building.

Suite 6 features a largely open floor plan ideal for collaborative teams, creative users, or professional office operations — with multiple windows facing the building's signature garden atrium.

A tranquil courtyard with mature landscaping and a central fountain brings natural light and calm into the workspace, creating an office environment.

## Suite Highlights

- Open bull-pen floor plan, ideal for collaborative teams
- Private conference room for client meetings
- Kitchenette / staff break room
- Direct access to building's garden atrium
- Ground-floor Space
- Abundant natural light through French doors
- Professional multi-tenant office building
- On-site visitor and tenant parking

SANTA BARBARA PROPERTY GROUP INC.  
Commercial Property Management

[www.sbpropertygroup.com](http://www.sbpropertygroup.com)  
**805.963.1971**

All information deemed reliable but not guaranteed. Square footage is approximate. Contact listing agent for full terms.

OPEN WORK AREA



CONFERENCE ROOM



GARDEN ATRIUM



KITCHENETTE



BUILDING ENTRY



FLOOR PLAN

1933 Cliff Drive, Suite 6

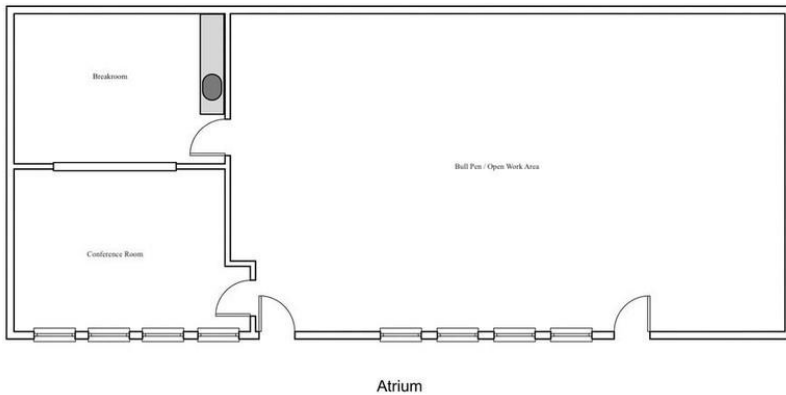

Efficient Layout,  
*Flexible Use*

- Bull Pen / Open Work Area
  - Conference Room
  - Break Room / Kitchenette
  - Atrium with garden setting
  - Ground Floor Suite
  - Common Area Restrooms
  - Private Restroom with Shower
- 1,497 RSF Total

The Mesa — Santa Barbara's Premier Office Neighborhood

Located in the heart of the Mesa neighborhood, 1933 Cliff Drive is surrounded by restaurants, coffee shops, groceries, banking, and daily amenities — all within a short walk. The Pacific Ocean is visible just blocks away, making this one of the most enviable office addresses in Santa Barbara. A rare Mesa vacancy — ideal for tenants seeking a bright, open, and inspiring workspace in a highly convenient location.

SANTA BARBARA PROPERTY GROUP INC.  
*Commercial Property Management*

[www.sbpropertygroup.com](http://www.sbpropertygroup.com)  
**805.963.1971**